

# PULSAR

INSTRUCTION MANUAL FOR WATCH CALIBRE  
V041



**WARNING**



**THIS PRODUCT CONTAINS A BUTTON BATTERY**

If swallowed or placed inside any part of the body, the battery can cause severe or fatal injuries within 2 hours or less.

Button batteries are hazardous whether new or used. Keep batteries out of reach of children.

If you think the battery may have been swallowed or placed inside any part of the body, seek immediate medical attention. Contact the Australian Poisons Information Centre immediately on 13 11 26 (New Zealand 0800 764 766) for 24 / 7 fast, expert advice.

# PULSAR

## CAL. V011, V041 ALARM CHRONOGRAPH

- Analogue time and digital time/calendar
- Regular alarm
- Stopwatch
- Illuminating light (for Cal. V011)

## DISPLAY AND CROWN/BUTTONS



- With each press of **button A**, the digital display changes as follows:

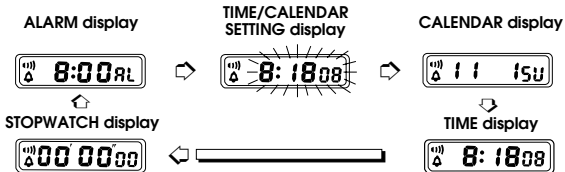

## SCREW DOWN CROWN

[for models with screw down crown]

### Unlocking the crown

- 1 Turn Crown counterclockwise until you no longer feel the threads turning.
- 2 Crown can be pulled out.



### Locking the crown

- 1 Push Crown back in to normal position.
- 2 Turn Crown clockwise while pressing it lightly until tight.



## DIGITAL TIME/CALENDAR SETTING

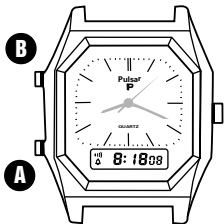

**A**

Press to show TIME/CALENDAR SETTING display.



**B**

Select the digits to be adjusted.\*



**A**

Set the flashing digits.



**B**

Press to show TIME/CALENDAR SETTING display.



**A**

Press to show CALENDAR display.

### \* Selection of the digits

TIME/CALENDAR SETTING display > Seconds > Minutes > Hour

▼  
▲ Day < Month < Date < 12-/24-hour indication

## ANALOGUE TIME SETTING

- Be sure to set the digital time first before setting the analogue time.

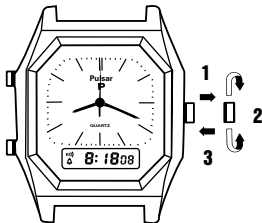

### CROWN

- 1 Pull out when Second hand is at the 12 o'clock position.
- 2 Turn to set Hour and Minute hands.
- 3 Push back when the seconds in the digital time display count "00".

## ILLUMINATING LIGHT (for Cal. V011)

- The illuminating light is activated by continuously pressing **button B** in the TIME or CALENDAR display.

*\* The light intermittently illuminates the display to save the energy of the battery, and this is not a malfunction.*

# ALARM

## ALARM TIME SETTING

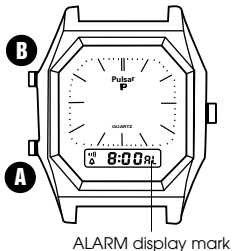

- A** Press to show ALARM display.
- B** Press to activate the alarm setting function.
- B** Select the digits to be adjusted.\*
- A** Set the flashing digits.
- B** Press to show ALARM display.

### \* Selection of the digits

ALARM display > Hour > Minutes  
▲



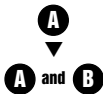
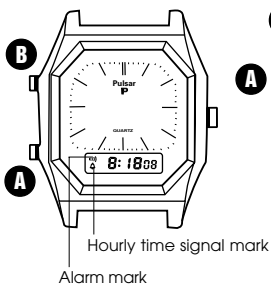

## ENGAGEMENT/DISENGAGEMENT OF ALARM AND HOURLY TIME SIGNAL



Press to show CALENDAR or TIME display.

With each simultaneous press, alarm and hourly time signal are engaged and disengaged in order:

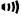
-  Both engaged  
↳
-  Alarm disengaged  
Hourly time signal engaged  
↳
-  Alarm engaged  
Hourly time signal disengaged  
↳
- Both disengaged

\* The alarm rings at the designated time for 20 seconds. To stop it manually, press button A or B.

# STOPWATCH

- The stopwatch measures up to 60 minutes in 1/100 second increments.

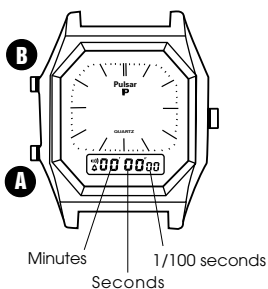

- A** Press to show STOPWATCH display.
- B** Start.
- B** Stop.
- B** Reset.

# NOTES ON OPERATING THE WATCH

## DIGITAL TIME/CALENDAR SETTING

- When setting the flashing digits, they are advanced quickly by keeping button A pressed, except the seconds and 12-/24-hour indication.
- **Seconds digits setting:**  
The seconds are reset to "00" by pressing button A.  
*\* When the seconds count any number from "30" to "59" and button A is pressed, one minute is added and the seconds are reset to "00".*
- The changeover between 12- and 24-hour indications is made alternately with each press of button A.



- When setting the hour in the 12-hour indication, check that AM/PM is properly set. Only "P" (PM) is displayed. For the AM setting, there is no indication.
- When the time function is displayed in the 24-hour indication, the alarm function is also displayed in the 24-hour indication.
- If the watch is left untouched in the TIME/CALENDAR SETTING display with the digits flashing, it will automatically return to the CALENDAR display in 1 to 2 minutes.
- The calendar automatically adjusts for odd and even months except February of leap years.

## **ANALOGUE TIME SETTING**

- When setting the minute hand, first advance it 4 to 5 minute ahead of the desired time and then turn it back to the exact minute.
- When the crown is pushed in, the minute hand may move slightly. However, this is not a malfunction.

## **ALARM**

- By pressing button B with the alarm setting function activated, the alarm mark is displayed and the alarm is automatically engaged.
- When setting the alarm in the 12-hour indication, check that AM/PM is properly set. Only "P" (PM) is displayed. For the AM setting, there is no indication.
- If the watch is left untouched in the ALARM display or with the digits flashing, it will automatically return to the CALENDAR display in 1 to 2 minutes.
- **Alarm test:**  
Press and hold buttons A and B at the same time in the TIME or CALENDAR display.

## **STOPWATCH**

- After the stopwatch has measured 60 minutes, it starts counting again from "00' 00" oo" as many times as necessary until it is stopped.
- When measuring a long period of time, return the STOPWATCH to the CALENDAR or TIME display after the stopwatch starts, to prevent any possible mistaken operation.

## BATTERY CHANGE

**2**  
**Years**

**Battery life : Approx. 2 years**

**Battery : SEIKO SR726W**

- *If the alarm is used for more than 20 seconds a day and/or the hourly time signal more than 24 times a day, the battery life may be less than the specified period.*
- *As the battery is inserted at the factory to check the function and performance of the watch, its actual life once in your possession may be less than the specified period.*
- *When the battery expires, be sure to replace it as soon as possible to prevent any malfunction.*
- *We recommend that you contact an AUTHORIZED PULSAR DEALER for battery replacement.*



## **WARNING**

- **Do not remove the battery from the watch.**
- **If it is necessary to take out the battery, keep it out of the reach of children. If a child swallows it, consult a doctor immediately.**
- **Never short-circuit, tamper with or heat the battery, and never expose it to fire. The battery may burst, become very hot or catch fire.**



## **CAUTION**

- **The battery is not rechargeable. Never attempt to recharge it, as this may cause battery leakage or damage to the battery.**

# TO PRESERVE THE QUALITY OF YOUR WATCH

## WATER RESISTANCE

### ● Non-water resistant



- If the watch becomes wet, have it checked by an **AUTHORIZED PULSAR DEALER** or **SERVICE CENTER**.

### ● Water resistant 5/10/15/20 bar



- Do not operate the crown or buttons when the watch is wet or in water.  
If used in sea water, rinse the watch in fresh water and dry it completely.
- When taking a shower with the water resistant 5 bar watch, or taking a bath with the water resistant 10, 15 or 20 bar watch, be sure to observe the following:
  - \* Do not operate the crown or buttons when the watch is wet with soapy water or shampoo.
  - \* If the watch is left in warm water, a slight time loss or gain may be caused. This condition, however, will be corrected when the watch returns to normal temperature.

\* Pressure in bar is a test pressure and should not be considered as corresponding to actual diving depth since swimming movement tends to increase the pressure at a given depth. Care should also be taken on diving into water.

\*\* We recommend that you wear a PULSAR Diver's Watch for scuba diving.

## TEMPERATURES



Your watch works with stable accuracy within a temperature range of 5° C and 35° C (41° F and 95° F).

Temperatures over 50° C (122° F) or below -5° C (+23° F) may cause a slight time loss or gain or battery leakage or shorten the battery life.

However, the above conditions will be corrected when the watch returns to normal temperature.

## MAGNETISM



The analogue unit of your watch will be adversely affected by strong magnetism, though the digital unit will not be affected. Keep the watch away from close contact with magnetic objects.

## CARE OF CASE AND BRACELET



To prevent possible rusting of the case and bracelet caused by dust, moisture and perspiration, wipe them periodically with a soft dry cloth.



## SHOCKS & VIBRATION



Light activities will not affect your watch, but be careful not to drop your watch or hit it against hard surfaces, as this may cause damage.

## CHEMICALS



Be careful not to expose the watch to solvents, mercury, cosmetic spray, detergents, adhesives or paints. Otherwise, the case, bracelet, etc. may become discolored, deteriorated or damaged.

## PERIODIC CHECK



It is recommended that the watch be checked once every 2 to 3 years. Have your watch checked by an **AUTHORIZED PULSAR DEALER** or **SERVICE CENTER** to ensure that the case, crown, buttons, gasket and crystal seal remain intact.

## PRECAUTION REGARDING CASE BACK PROTECTIVE FILM



If your watch has a protective film and/or a sticker on the case back, be sure to peel them off before using your watch.

## STATIC ELECTRICITY



The IC (Integrated Circuit) used in your watch will be affected by static electricity which may disturb the display. Keep the watch away from close contact with objects such as TV screens which emit strong static electricity.

## LIQUID CRYSTAL PANEL



The normal life expectancy for the liquid crystal panel of the watch is approximately 7 years. After that it may decrease in contrast, becoming difficult to read. If the watch is left at a temperature of more than 50°C for a long time, the quality of the liquid crystal panel may deteriorate. Please contact your **AUTHORIZED PULSAR DEALER** or **SERVICE CENTER** if you wish to have a new panel fitted (guaranteed one year).